

Office Protection Station II



- 8 outlets with 360J surge protection
- 4 surge protection only
 - 4 surge protection and power backup



Battery easy replacement

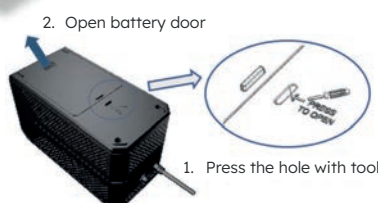

Note: Follow manual for details and safety requirement.

- 650VA/850VA Line Interactive UPS
- Build-in voltage regulator for reliable power quality
- Super fast charger shortens the charging time to 2-4 hours
- HID USB interface enables integration with built-in power management and auto shutdown features of Windows and Mac OS and Linux
- Supports loads with APFC (Active Power Factor Correction) switching power supply
- Multi outlet up to 8 pcs
- Support Surge protection
- Separated battery room and Support Battery easy replacement
- CE compliant
- 3 years NEXT Onsite warranty

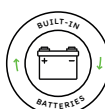

Office Protection Station II Selection Guide

MODEL	Office Protection Station II 650	Office Protection Station II 850
CAPACITY	650 VA / 360 W	850 VA / 480 W
INPUT		
Voltage	220/230/240 VAC	
Acceptable Voltage Range	170 - 280 VAC	
Frequency	45-55Hz	
OUTPUT		
Output Power Factor	0.55	0.56
Nominal Output Voltage	230 VAC	
Voltage Regulation (Line Mode)	±15%	
Voltage Regulation (Battery Mode)	±10%	
Frequency Range (Battery Mode)	50Hz ±1Hz	
Waveform (Battery Mode)	Modified Sinewave	
EFFICIENCY		
Line Mode	95%	
AVR Mode	88%	
Battery Mode	60%	
BATTERY		
Battery Type & Number	12 V / 9 Ah x 1	
Typical Recharge Time	2-4 hours to recover 90% capacity	
INDICATORS		
AC Mode	Green lighting	
Battery Mode	Green flashing every 10 seconds	
Low Battery (Batt. Mode)	Green flashing every second and red lighting	
Fault	Red lighting	
ALARM		
Battery Mode	Sounding every 10 seconds	
Low Battery (Batt. Mode)	Sounding every second	
Fault	Continuously sounding	
PHYSICAL		
Dimension, W x H x D (mm)	125 x 150 x 254	
Net Weight (kgs)	5,4	
ENVIRONMENT		
Humidity	0-90%	
Operating Temperature	0-40°C. (non-condensing)	
NEXT PART NUMBERS		
Office Protection Station II BE/FR	22323	22324
Office Protection Station NL/LU	22325	22326
NEXT 5+ warranty extension	11002	11002